

# SIMPLI-FLEX® SFP2000

## PORTION CUP DISPENSER

### FOR IN-COUNTER MOUNTING:

REFER TO CHART AND DIAGRAM TO ESTABLISH MOUNTING HOLE SIZE AND MINIMUM CLEARANCE FOR EASE OF INSTALLATION AND SERVICE. ALLOW AT LEAST 1/4" (6.35 mm) BETWEEN DISPENSERS (DIMENSION "A")

1. Lay out and cut hole(s) for dispenser.
2. Remove clamp ring (1), gasket (2), pusher (3), and spring (4). (See Figure 1)
3. Pre-drill holes for #8 x 3/4" mounting screws (6). Slide dispenser into hole and secure through keyhole slots with screws provided.
4. Reassemble dispenser.

### LOADING THE DISPENSER:

Your Modular SIMPLI-FLEX® dispenser is completely self-adjusting.

1. Unwrap cups and gently push into completely assembled dispenser tube. (See Figure 2)

### DISASSEMBLY: (Refer to Figure #1)

1. Remove decorative clamp ring.
2. Peel off gasket from lip of dispenser.  
NOTE: CAUTION when removing gasket, pusher may be under small amount of spring tension.
3. Remove pusher from spring.
4. Remove spring from dispenser.

### CLEANING THE DISPENSER:

Your Modular SIMPLI-FLEX® dispenser is designed to provide an easy means of dispensing. The dispenser can be disassembled without tools to make regular cleaning simple!

Please clean dispenser before use. Regular cleaning will prolong the life of the dispenser, keep it looking new and ensure sanitary dispensing.

1. Remove dispenser from mounting location.
2. Remove clamp ring (1), gasket (2), pusher (3), and spring (4). (See Figure 1)
3. Clean clamp ring and gasket in hot, soapy water. Air dry.  
NOTE: these parts are dishwasher safe.
4. Rinse dispenser tube and wipe with a non-toxic cleaner/sanitizer.
5. Reassemble dispenser in reverse of above.

## REFERENCE DIMENSIONS

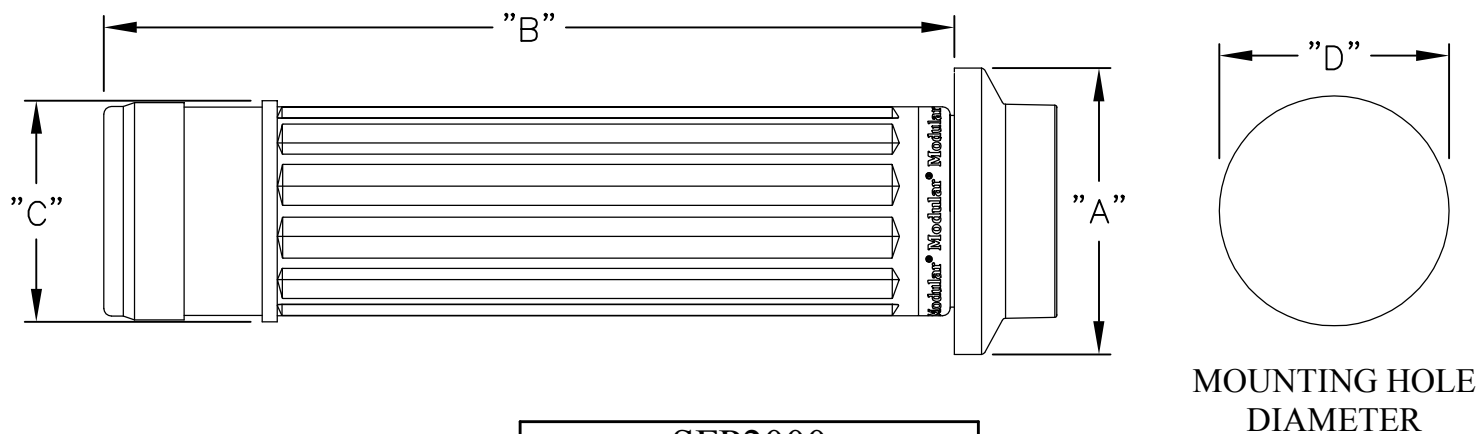

SFP2000	
INCHES (METRIC)	
A	4-11/16 (119.05mm)
B	14.00 (355.6mm)
C	3-5/8 (92.08mm)
D	3-3/4 (95.25mm)

**MODULAR®**  
**DISPENSING SYSTEMS**  
DIVISION OF TOMLINSON INDUSTRIES  
13700 Broadway Ave.  
Cleveland Ohio 44125-1992  
Phone: 216/587-3400  
Fax: 216/587-0733  
www.tomlinsonind.com  
*World Class, Worldwide*



# SIMPLI-FLEX® SFP2000

## PORTION CUP DISPENSER

CATALOG NUMBER	APPLICATION	DESCRIPTION
1015572	Elevator type, counter mount, for paper & plastic portion cups	SFP2000 PORTION CUP DISPENSE

ITEM	DESCRIPTION	NUMBER	QTY
1	SF CLAMP RING	1905845	1
2	GASKET 61/64" I.D. * Factory Installed *	1915669	1
	1-7/16" I.D.	1915581	1
	1-27/32" I.D.	1915592	1
3	PUSHER	1915573	1
4	SPRING	1904526	1
5	TUBE	1915573	1
6	SCREW	1907911	3
7	MOUNTING RING	1905297	1

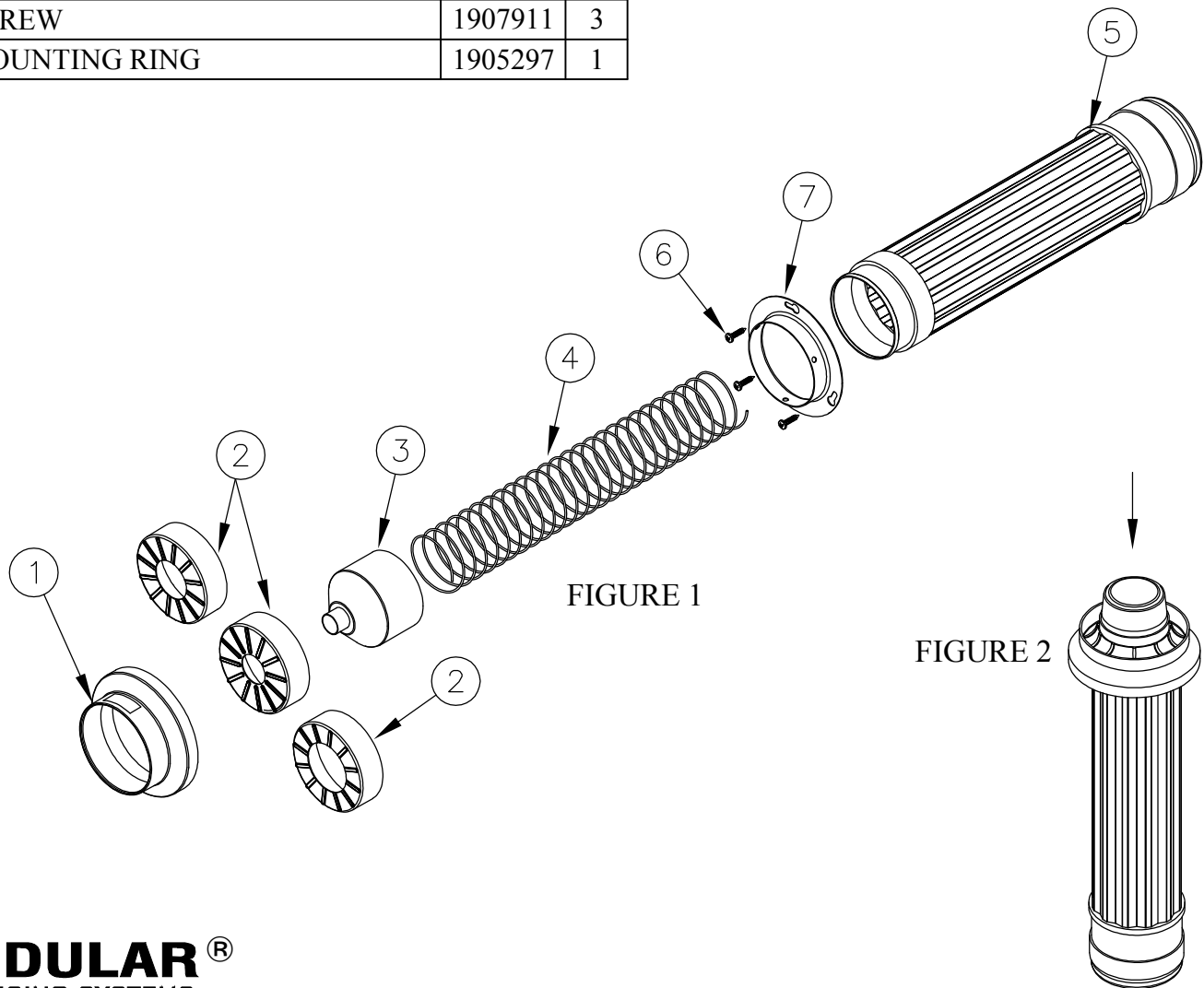

**MODULAR®**

**DISPENSING SYSTEMS**

DIVISION OF TOMLINSON INDUSTRIES

13700 Broadway Ave.

Cleveland Ohio 44125-1992

Phone: 216/587-3400

Fax: 216/587-0733

www.tomlinsonind.com

World Class, Worldwide

© Tomlinson Industries 2000

